

SECTION **PWO**
POWER OUTLET

A
B
C
D
E
F
G
H
I
J
K
L
N
O
P

CONTENTS

DTC/CIRCUIT DIAGNOSIS	2	FRONT POWER SOCKET : Removal and Installation	7
POWER SOCKET	2	CONSOLE POWER SOCKET	7
Wiring Diagram - POWER SOCKET -	2	CONSOLE POWER SOCKET : Exploded View	8
PRECAUTION	6	CONSOLE POWER SOCKET : Removal and Installation	8
PRECAUTIONS	6	REAR POWER SOCKET	8
Precaution for Supplemental Restraint System (SRS) "AIR BAG" and "SEAT BELT PRE-TENSIONER"	6	REAR POWER SOCKET : Exploded View	8
REMOVAL AND INSTALLATION	7	REAR POWER SOCKET : Removal and Installation	8
POWER SOCKET	7	LUGGAGE ROOM POWER SOCKET	9
FRONT POWER SOCKET	7	LUGGAGE ROOM POWER SOCKET : Exploded View	9
FRONT POWER SOCKET : Exploded View	7	LUGGAGE ROOM POWER SOCKET : Removal and Installation	9

PWO

POWER SOCKET

< DTC/CIRCUIT DIAGNOSIS >

DTC/CIRCUIT DIAGNOSIS

POWER SOCKET

Wiring Diagram - POWER SOCKET -

INFOID:000000003882835

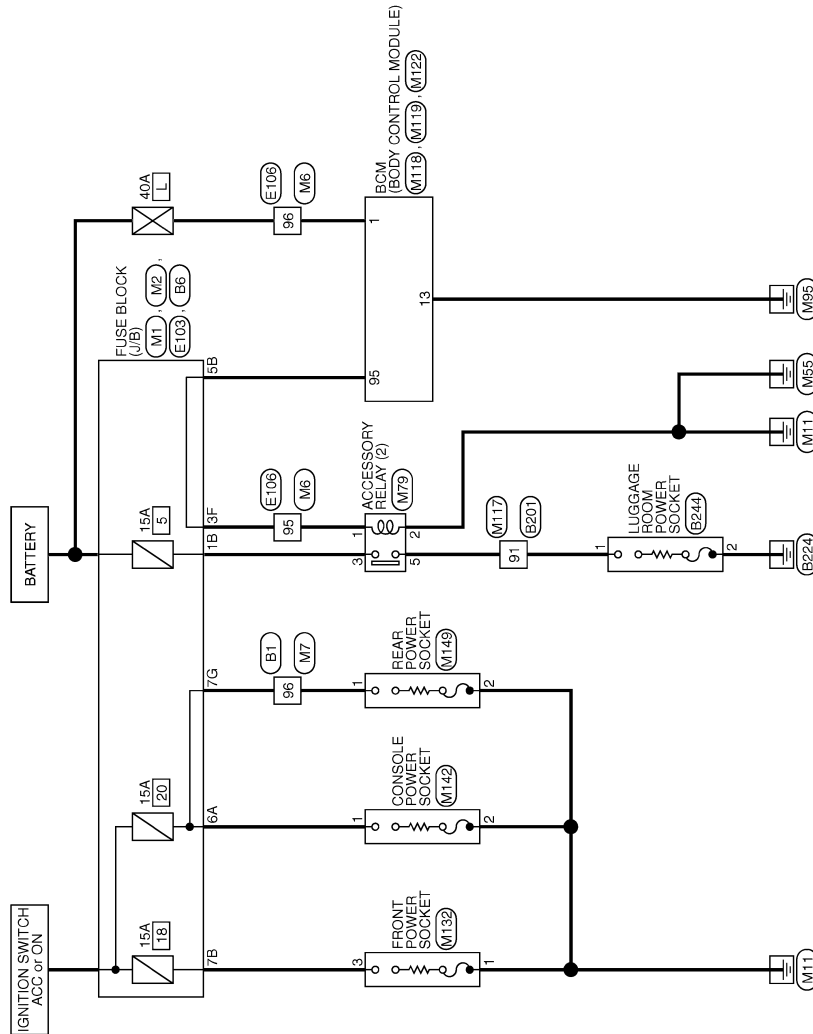

POWER SOCKET

2008/03/04

JCMWM1986GB

POWER SOCKET

< DTC/CIRCUIT DIAGNOSIS >

POWER SOCKET









Connector No. B1	WIRE TO WIRE TH80FW-CS16-TM4		Terminal No. 96	Color of Wire O	Signal Name [Specification]	Terminal No. 96	Color of Wire O	Signal Name [Specification]
Connector Name WIRE TO WIRE	TH80FW-CS16-TM4							
Connector Type TH80FW-CS16-TM4								
Connector No. B201	WIRE TO WIRE TH80FW-CS16-TM4		Terminal No. 91	Color of Wire V	Signal Name [Specification]	Terminal No. 91	Color of Wire V	Signal Name [Specification]
Connector Name WIRE TO WIRE	TH80FW-CS16-TM4							
Connector Type TH80FW-CS16-TM4								
Connector No. B6	FUSE BLOCK (J/B) NS12PER-CS		Terminal No. TG	Color of Wire O	Signal Name [Specification]	Terminal No. TG	Color of Wire O	Signal Name [Specification]
Connector Name FUSE BLOCK (J/B)	NS12PER-CS							
Connector Type NS12PER-CS								
Connector No. E103	FUSE BLOCK (J/B) NS16FW-CS		Terminal No. 3F	Color of Wire Y	Signal Name [Specification]	Terminal No. 3F	Color of Wire Y	Signal Name [Specification]
Connector Name FUSE BLOCK (J/B)	NS16FW-CS							
Connector Type NS16FW-CS								
Connector No. E106	WIRE TO WIRE TH80FW-CS16-TM4		Terminal No. 95	Color of Wire Y	Signal Name [Specification]	Terminal No. 95	Color of Wire Y	Signal Name [Specification]
Connector Name WIRE TO WIRE	TH80FW-CS16-TM4							
Connector Type TH80FW-CS16-TM4								
Connector No. E108	FUSE BLOCK (J/B) NS10FW-CS		Terminal No. 1B	Color of Wire LG	Signal Name [Specification]	Terminal No. 1B	Color of Wire LG	Signal Name [Specification]
Connector Name FUSE BLOCK (J/B)	NS10FW-CS							
Connector Type NS10FW-CS								
Connector No. M1	FUSE BLOCK (J/B) NS08FW-M2		Terminal No. 6A	Color of Wire Y	Signal Name [Specification]	Terminal No. 6A	Color of Wire Y	Signal Name [Specification]
Connector Name FUSE BLOCK (J/B)	NS08FW-M2							
Connector Type NS08FW-M2								
Connector No. M2	FUSE BLOCK (J/B) NS10FW-CS		Terminal No. 1B	Color of Wire LG	Signal Name [Specification]	Terminal No. 1B	Color of Wire LG	Signal Name [Specification]
Connector Name FUSE BLOCK (J/B)	NS10FW-CS							
Connector Type NS10FW-CS								
Connector No. B244	LUGGAGE ROOM POWER SOCKET P02FB-Z		Terminal No. 1	Color of Wire V	Signal Name [Specification]	Terminal No. 1	Color of Wire V	Signal Name [Specification]
Connector Name LUGGAGE ROOM POWER SOCKET	P02FB-Z							
Connector Type P02FB-Z								
Terminal No. 2	Color of Wire B	Signal Name [Specification]	Terminal No. 2	Color of Wire B	Signal Name [Specification]	Terminal No. 2	Color of Wire B	Signal Name [Specification]

A
B
C
D
E
F
G
H
I
J
K
L
PWO
N
O
P

POWER SOCKET

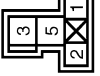
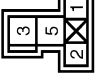
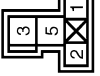
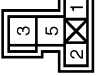
< DTC/CIRCUIT DIAGNOSIS >

POWER SOCKET

Connector No. M16	WIRE TO WIRE	TH80MW-CS16-TM4		Terminal No. 95	Color of Wire G	Signal Name [Specification]	
Connector No. M17	WIRE TO WIRE	TH80MW-CS16-TM4		Terminal No. 96	Color of Wire O	Signal Name [Specification]	
Connector No. M18	BCM (BODY CONTROL MODULE)	MD3FB-LC		Terminal No. 1	Color of Wire W	Signal Name [Specification]	BAT (F/L)
Connector No. M19	BCM (BODY CONTROL MODULE)	NS16FW-CS		Terminal No. 13	Color of Wire B	Signal Name [Specification]	GND
Connector No. M22	BCM (BODY CONTROL MODULE)	TH40FB-NH		Terminal No. 95	Color of Wire O	Signal Name [Specification]	ACC RELAY CONT
Connector No. M79	ACCESSORY RELAY (2)	MS2FEL-M2-LC		Terminal No. 1	Color of Wire G	Signal Name [Specification]	
Connector No. M79	ACCESSORY RELAY (2)	MS2FEL-M2-LC		Terminal No. 2	Color of Wire B	Signal Name [Specification]	
Connector No. M79	ACCESSORY RELAY (2)	MS2FEL-M2-LC		Terminal No. 3	Color of Wire LG	Signal Name [Specification]	
Connector No. M79	ACCESSORY RELAY (2)	MS2FEL-M2-LC		Terminal No. 5	Color of Wire L	Signal Name [Specification]	
Connector No. M117	WIRE TO WIRE	TH80MW-CS16-TM4		Terminal No. 91	Color of Wire L	Signal Name [Specification]	
Connector No. M132	FRONT POWER SOCKET	NS30FW-CS		Terminal No. 1	Color of Wire B	Signal Name [Specification]	
Connector No. M132	FRONT POWER SOCKET	NS30FW-CS		Terminal No. 3	Color of Wire L	Signal Name [Specification]	

JCMWM1988GB

POWER SOCKET

< DTC/CIRCUIT DIAGNOSIS >

A
B
C
D
E
F
G
H
I
J
K
L
N
O
P

POWER SOCKET

Connector No.	M142
Connector Name	CONSOLE POWER SOCKET
Connector Type	FDPEF-Z



Terminal No.	Color of Wire	Signal Name [Specification]
1	Y	-
2	B	-

Connector No.	M148
Connector Name	REAR POWER SOCKET
Connector Type	FD2FB-Z



Terminal No.	Color of Wire	Signal Name [Specification]
1	O	-
2	B	-

JCMWM1989GB

PWO

PRECAUTIONS

< PRECAUTION >

PRECAUTION

PRECAUTIONS

Precaution for Supplemental Restraint System (SRS) "AIR BAG" and "SEAT BELT PRE-TENSIONER"

INFOID:000000003882846

The Supplemental Restraint System such as "AIR BAG" and "SEAT BELT PRE-TENSIONER", used along with a front seat belt, helps to reduce the risk or severity of injury to the driver and front passenger for certain types of collision. This system includes seat belt switch inputs and dual stage front air bag modules. The SRS system uses the seat belt switches to determine the front air bag deployment, and may only deploy one front air bag, depending on the severity of a collision and whether the front occupants are belted or unbelted. Information necessary to service the system safely is included in the "SRS AIR BAG" and "SEAT BELT" of this Service Manual.

WARNING:

- To avoid rendering the SRS inoperative, which could increase the risk of personal injury or death in the event of a collision which would result in air bag inflation, all maintenance must be performed by an authorized NISSAN/INFINITI dealer.
- Improper maintenance, including incorrect removal and installation of the SRS, can lead to personal injury caused by unintentional activation of the system. For removal of Spiral Cable and Air Bag Module, see the "SRS AIR BAG".
- Do not use electrical test equipment on any circuit related to the SRS unless instructed to in this Service Manual. SRS wiring harnesses can be identified by yellow and/or orange harnesses or harness connectors.

PRECAUTIONS WHEN USING POWER TOOLS (AIR OR ELECTRIC) AND HAMMERS

WARNING:

- When working near the Air Bag Diagnosis Sensor Unit or other Air Bag System sensors with the ignition ON or engine running, DO NOT use air or electric power tools or strike near the sensor(s) with a hammer. Heavy vibration could activate the sensor(s) and deploy the air bag(s), possibly causing serious injury.
- When using air or electric power tools or hammers, always switch the ignition OFF, disconnect the battery, and wait at least 3 minutes before performing any service.

POWER SOCKET

< REMOVAL AND INSTALLATION >

REMOVAL AND INSTALLATION

POWER SOCKET

FRONT POWER SOCKET

FRONT POWER SOCKET : Exploded View

INFOID:000000003882840

- 1 : Inner socket
- 2 : Ring

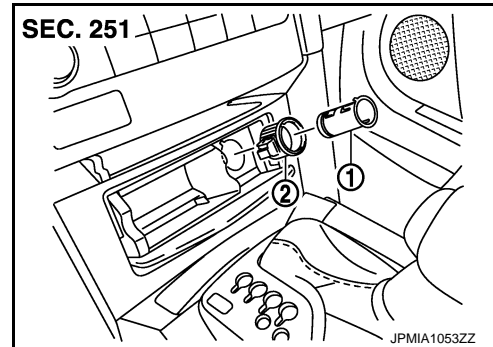

FRONT POWER SOCKET : Removal and Installation

INFOID:000000003882902

REMOVAL

1. Remove console pocket assembly. Refer to [IP-22. "Exploded View"](#).
2. Disconnect power socket connector (A) from reverse side inner socket (1).

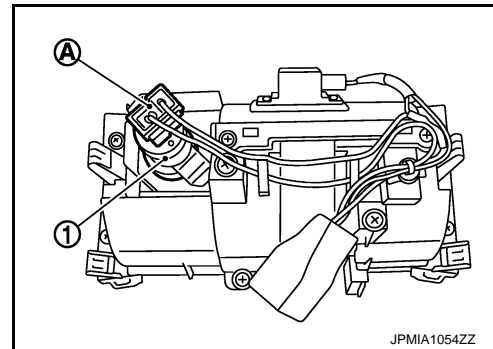

3. Pull out inner socket (1) by pushing the ring pawl (B) from the inner socket hole (square) (C).

A : Cut out

4. Remove ring (2) from console pocket assembly while pressing pawls.

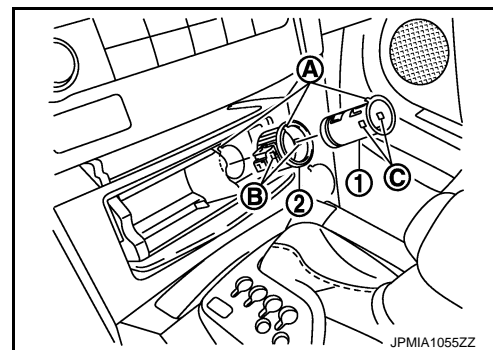

INSTALLATION

Install in the reverse order of removal.

NOTE:

Align the cut outs of inner socket, ring, and console pocket assembly.

CONSOLE POWER SOCKET

A
B
C
D
E
F
G
H
I
J
K
L
PWO
N
O
P

POWER SOCKET

< REMOVAL AND INSTALLATION >

CONSOLE POWER SOCKET : Exploded View

INFOID:000000003882903

- 1 : Inner socket
- 2 : Ring

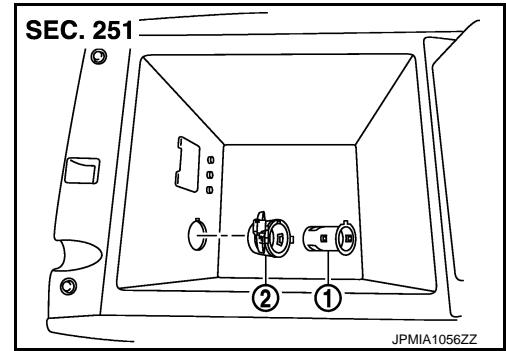

CONSOLE POWER SOCKET : Removal and Installation

INFOID:000000003882904

REMOVAL

1. Remove center console assembly. Refer to [IP-22, "Exploded View"](#).
2. Disconnect power socket connector (A).

B : Cut out

3. Pull out inner socket (1) by pushing the ring pawl (C) from the inner socket hole (square) (D).
4. Remove ring (2) from console box assembly while pressing pawls.

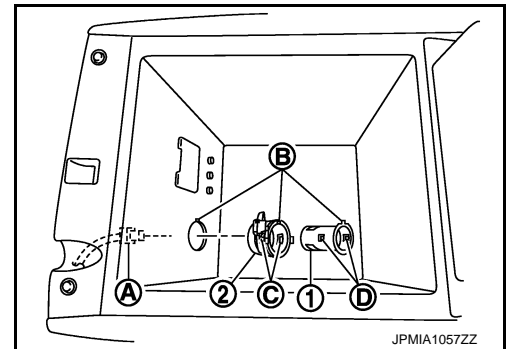

INSTALLATION

Install in the reverse order of removal.

NOTE:

Align the cut outs of inner socket, ring, and console box assembly.

REAR POWER SOCKET

REAR POWER SOCKET : Exploded View

INFOID:000000003882847

- 1 : Inner socket
- 2 : Ring
- 3 : Retainer

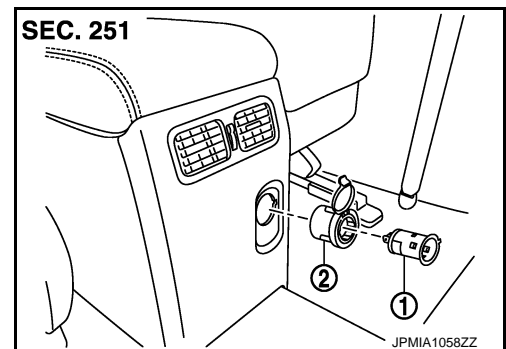

REAR POWER SOCKET : Removal and Installation

INFOID:000000003882848

REMOVAL

1. Remove console rear finisher. Refer to [IP-22, "Exploded View"](#).

POWER SOCKET

< REMOVAL AND INSTALLATION >

2. Disconnect power socket connector (A).

B : Cut out

3. Pull out inner socket (1) by pushing the ring pawl (C) from the inner socket hole (square) (D).
4. Remove ring (2) from console rear finisher while pressing pawls.

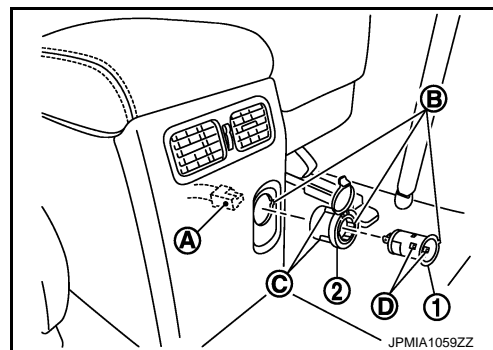

INSTALLATION

Install in the reverse order of removal.

NOTE:

Align the cut outs of inner socket, ring, and console rear finisher.

LUGGAGE ROOM POWER SOCKET

LUGGAGE ROOM POWER SOCKET : Exploded View

INFOID:000000003882844

- 1 : Inner socket
- 2 : Ring
- 3 : Retainer

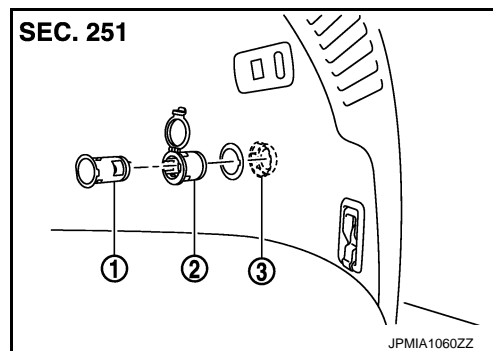

LUGGAGE ROOM POWER SOCKET : Removal and Installation

INFOID:000000003882845

REMOVAL

1. Remove clips on the back of the luggage side finisher lower (RH) to obtain space for work. Refer to [INT-28. "Exploded View"](#).
2. Disconnect power socket connector (A).

B : Cut out

3. Remove retainer (1) and remove power socket assembly.
4. Pull out inner socket (2) by pushing the ring pawl (C) from the inner socket hole (square) (D).
5. Remove ring (3) from luggage side finisher lower (RH) while pressing pawls.

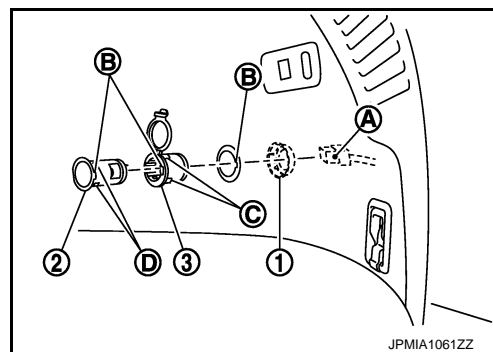

INSTALLATION

Install in the reverse order of removal.

NOTE:

Align the cut outs of inner socket, ring, and luggage side finisher lower (RH).

A
B
C
D
E
F
G
H
I
J
K
L
PWO
N
O
P